

# Land Use Bylaw 3357/2006



North

Scale 1:5,000

© The City of Red Deer



	Land Use District Boundary		Historical Preservation Sites
R1	Land Use District		Historically Significant Sites
	Exception to District	1000	Historical Site Number
1000	Exception Number		City Boundary
• • •	Exempted from District	123	Civic Address
2a	Exempted Number		Railway
V18	Height Overlay District		Proposed Lots
D95	Density Overlay District		
s	Secondary Suite Permitted		

Printed on Jun 18, 2013

Land Use Districts

**R20**

SE¼ Sec35 38-27-W4

Refer to Constraints Map

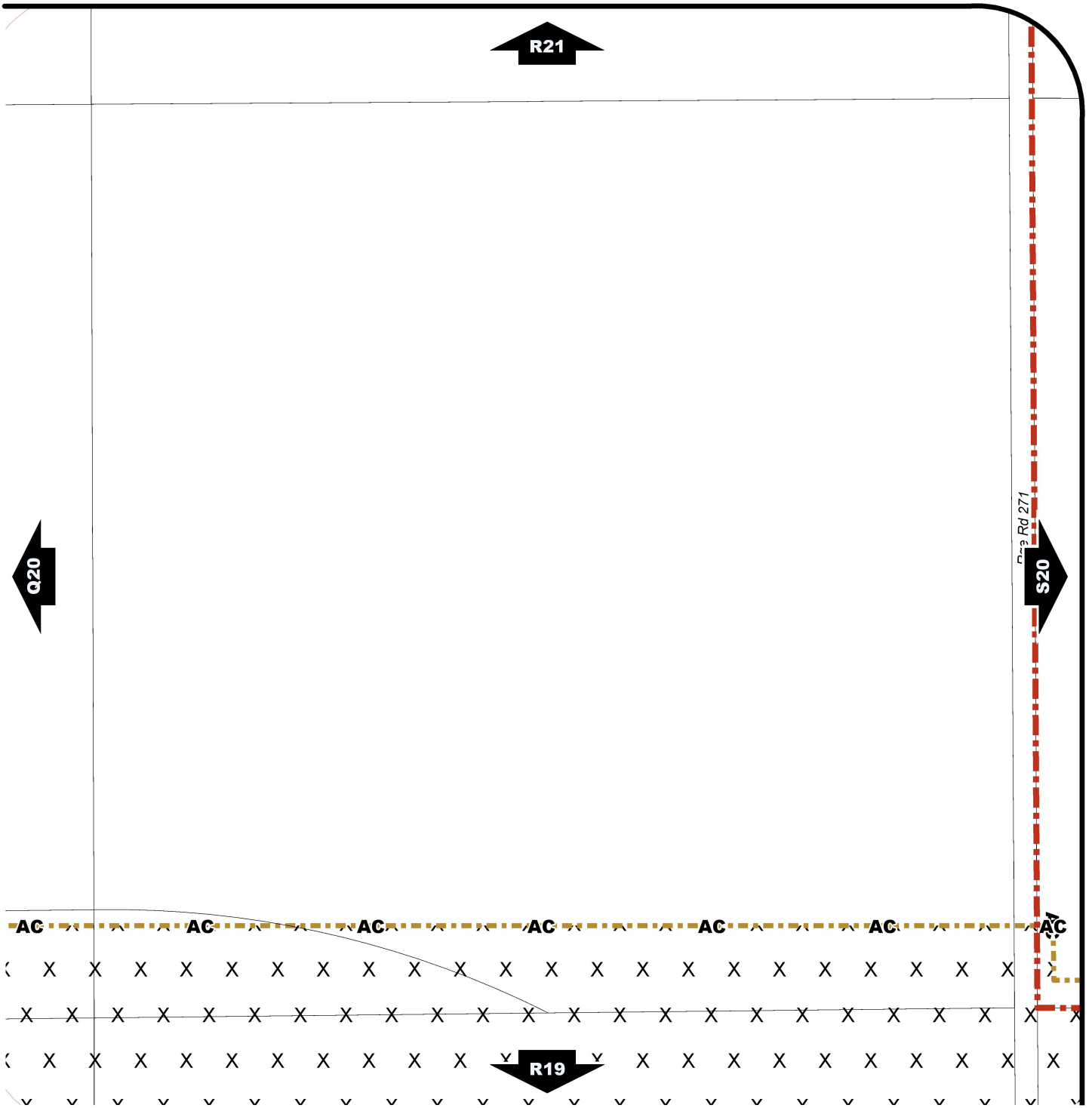

# Land Use Bylaw 3357/2006



North

Scale 1:5,000

© The City of Red Deer



- |  |  |  |                                |
|--|--|--|--------------------------------|
|  | Escarpment Area                                  |  | Gaetz - Ross Heritage Area     |
|  | Flood Fringe                                     |  | Business Revitalization Zone   |
|  | Floodway   |  | Historical Preservation Sites  |
|  | Landfill Site (approximate)                      |  | Historically Significant Sites |
|  | Landfill Setback                                 |  | Historical Site Number         |
|  | Major Entry Area                                 |  | City Boundary                  |
|  | TransCanada Pipeline Setback                     |  | Civic Address                  |
|  | AltaLink Consultation/Potential Constraints Area |  | Railway                        |
|  | Overlay District                                 |  | Proposed Lots                  |

Printed on Jun 18, 2013

Land Use Constraints

**R20**

SE¼ Sec35 38-27-W4