

# VIEWPOINT GALLERY

## CULTURE SERVICES BUILDING

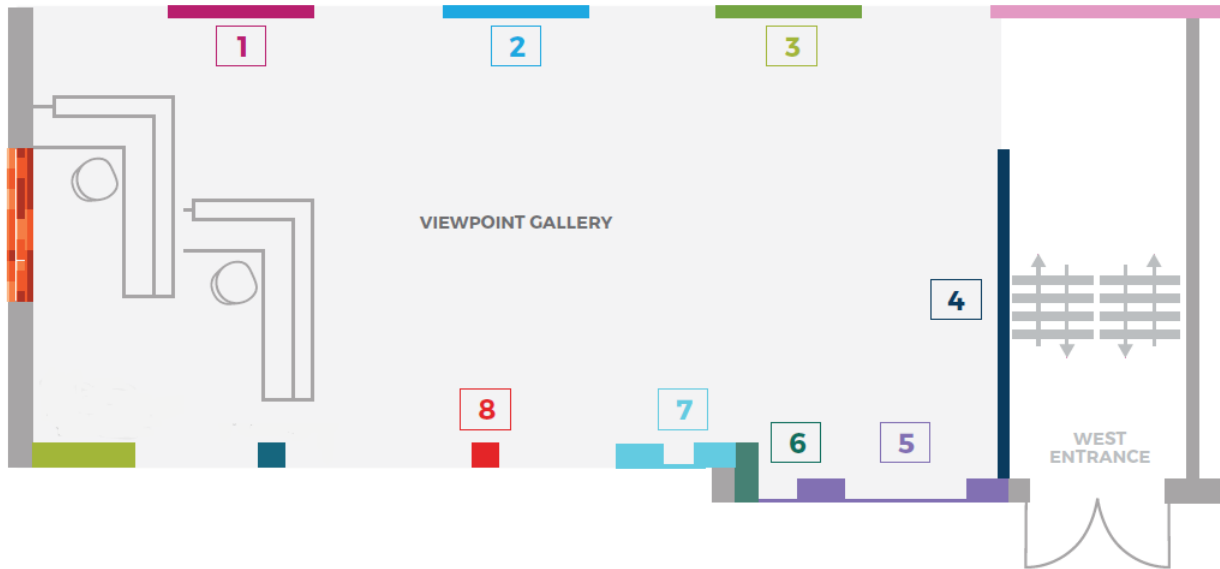
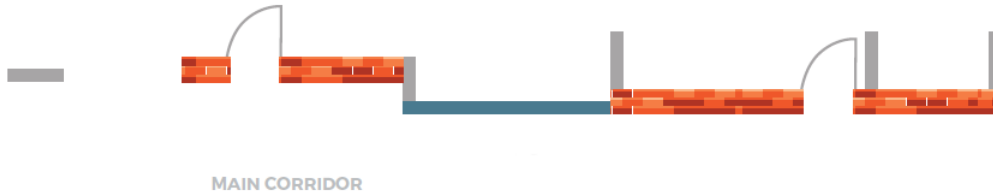

**1**

**W x H = 93" x 94"**

IMPEDIMENTS:

- emergency light fixture 8" down from ceiling
- thermostat and light switches 16 ¾" in from edge of wall
- rubber baseboards, 4 ½" high

OTHER MATERIAL CONSIDERATIONS:

- plywood under drywall - full wall
- opposite side of wall has partial band plywood layer

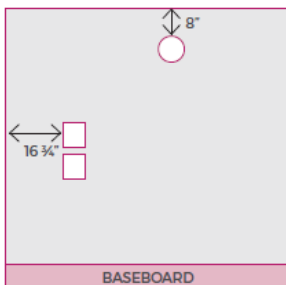

**2**

**W x H = 96 ½" x 94"**

IMPEDIMENTS:

- rubber baseboards, 4 ½" high
- OTHER MATERIAL CONSIDERATIONS:
- plywood under drywall - full wall
  - opposite side of wall has partial band plywood layer

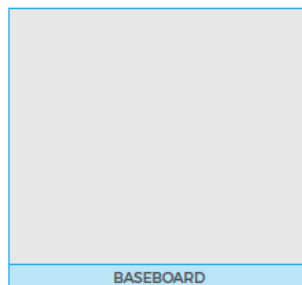

**3**

**W x H = 93 ½" x 94"**

IMPEDIMENTS:

- emergency lighting fixture 8" from ceiling, off
- rubber baseboards, 4 ½" high

OTHER MATERIAL CONSIDERATIONS:

- plywood under drywall - full wall
- opposite side of wall has partial band plywood layer

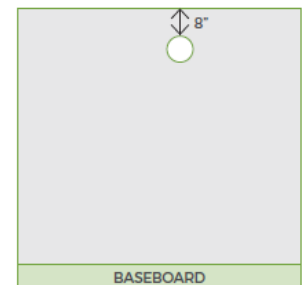

**4****W x H = 210" x 126"**IMPEDIMENTS:

- rubber baseboards, 4 ½" high
- fire alarm indicator: is 4 ¾" wide, 84 ¾" up from floor, 74 ¾" in from left wall edge, off centre
- outlet, 16" up from floor in centre of wall

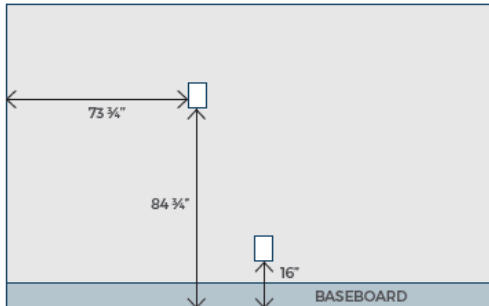
**5****W x H = 160 ¾" x 106"**IMPEDIMENTS:

- radiator - 5" deep, 20" high from floor
- large window + small window, upper right portion of wall

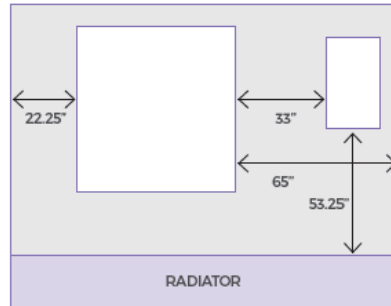
**6****W x H = 25" x 106"**IMPEDIMENTS:

- radiator - 5" deep, 20" high from floor

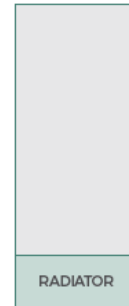
**7****W x H = 83 ½" x 106"**IMPEDIMENTS:

- radiator - 5" deep, 20" high from floor
- window, upper portion of wall

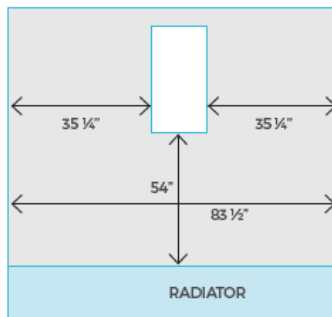
**8****W x H = 21 ¾" x 106"**IMPEDIMENTS:

- radiator - 5" deep, 20" high from floor
- fire alarm indicator, 64 ½" up from radiator

ADDITIONAL NOTES:

- moveable plinths are available in various sizes for sculptural or 3-D items.
- plinths are painted white and some have glass
- gallery is located in a lobby area including two permanent work stations.